

# HANLO

FIXTURE GAGE  
COMPONENTS

CATALOG 82D

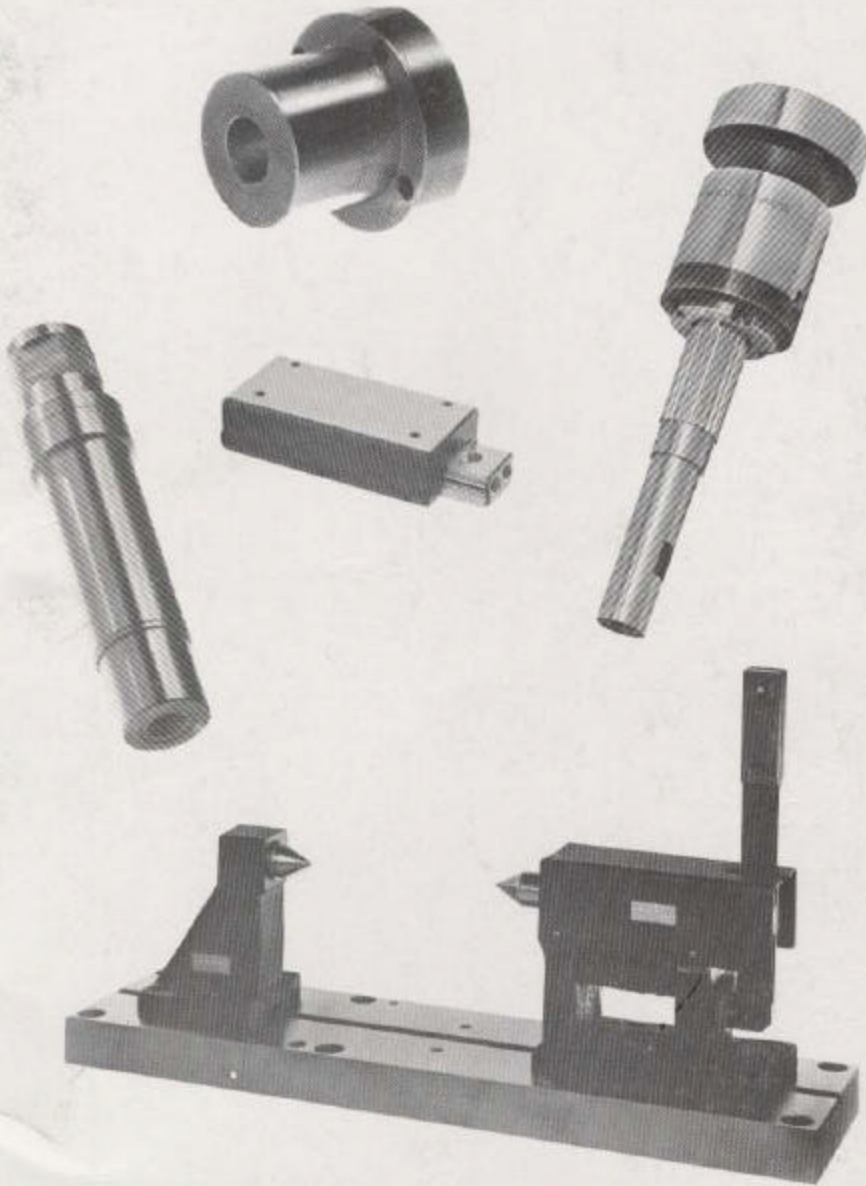

HANLO  
GAGES

**HANLO**  
GAGE & ENGINEERING CO.

# TABLE OF CONTENTS

<u>Title</u>	<u>Page No.</u>
Ball Slides .....	1-3
Center Assemblies .....	4-5
Fixed Center Assemblies	
Model F-325 .....	6
Centers for Model F-325 .....	7
Model F-450 .....	8
Centers for Model F-450 .....	9
Spring Loaded Center Assemblies	
Model R-325 .....	10
Centers for Model R-325 .....	11
Model R-450 .....	12
Centers for Model R-450 .....	13
Retractable Center Assemblies	
Model RH-325 .....	14
Centers for Models RH-325 and RHT-325 .....	15
Model RH-450 .....	16
Centers for Models RH-450 and RHT-450 .....	17
Model RHT-325 .....	18
Model RHT-450 .....	19
Extended Travel Center Assembly	
Model RHTIS-450 .....	20
Centers for Model RHTIS-450 .....	21
Variable Pressure Center Assembly	
Model WTCA-450 .....	22
Centers for Model WTCA-450 .....	23
Ordering Instructions for Center Assemblies .....	24
Standard Base Plates .....	25
Hydraulic Arbors and Chucks .....	26-27
Positive Centering .....	28
Gears-Splines .....	29
Quotations .....	30
Applications .....	31-33

# BALL SLIDES



## FEATURES

- Off the Shelf
  - Low Cost
  - Delivery
  - Ready for Mounting
- Precision Assemblies
  - Accuracy of .0002 in their entire travel in either a horizontal or vertical mounted position
  - Friction free movement

NOTE: Do not subject Ball Slide to any type of shock.  
Balls and ways may become brinelled.

- Travel
  - 1" to 6" of travel on standard models
- 2 Models

Light Duty



Model 23-1  
24-2  
25-3  
26-4

Medium Duty



Model 34-3  
37-6

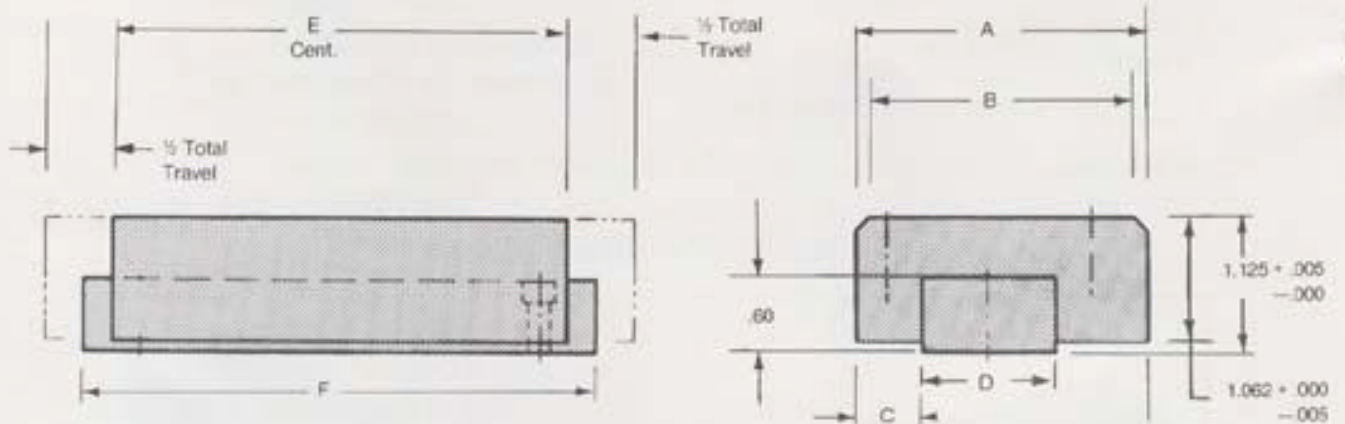
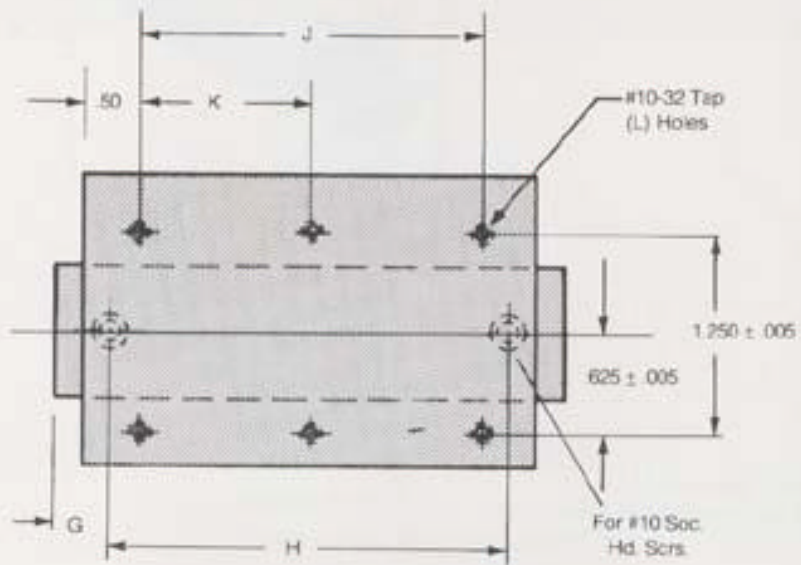

TYPE	MODEL NO.	A	B	C	D	E	F	G	H	J	K	L	TRAVEL
LIGHT DUTY	23-1	2.00	1.88	.405	.94	3.00	3.50	.50	2.50	2.00	0	4	1.0
	24-2	2.00	1.88	.405	.94	4.00	4.50	.50	3.50	3.00	0	4	2.0
	25-3	2.00	1.88	.405	.94	5.00	5.50	.50	4.50	4.00	0	4	3.0
	26-4	2.00	1.88	.405	.94	6.00	6.50	.50	5.50	5.00	2.50	6	4.0
MEDIUM DUTY	34-3	2.75	2.50	.554	1.49	4.00	4.50	.562	3.375	3.00	0	4	2.25
	37-6	2.75	2.50	.554	1.49	7.00	7.50	.562	6.375	6.00	3.00	6	6.0

## VARIATIONS

- Key Ways
- Dowel Holes — Top Plate
- Dowel Holes — Mounting Plate
- Hole Pattern — Other than Standard

Supply Hanlo with engineering drawing for quoting.

Hanlo's engineering staff can assist you with your variations and gaging problems. Your inquiry will receive prompt attention.

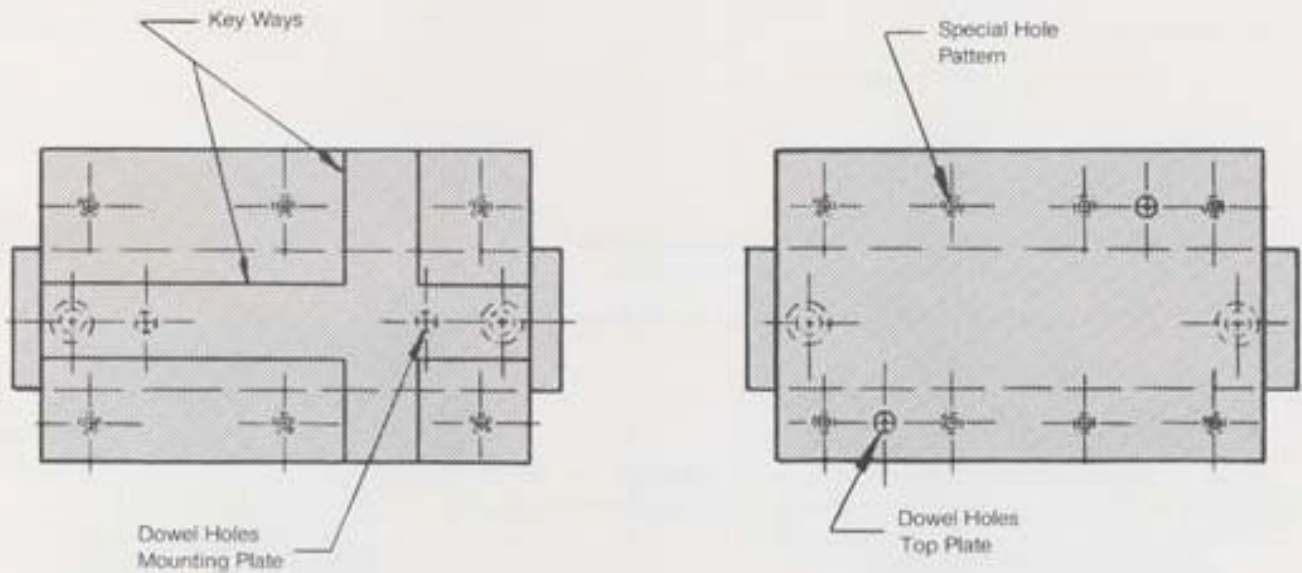

NOTE: Due to the precision of these units, all alterations must be made by Hanlo or our guarantee of accuracy is voided.



## **CENTER ASSEMBLIES**

### **FEATURES**

- Off the Shelf
  - Low cost
  - Delivery
  - Ready for mounting
- Accuracy
  - Center height held  $\pm .0001$  inch
- Reliability
  - Rugged construction
  - Centers available in tool steel or carbide, ground to precision ball type or production dimensions
  - Center assemblies covered to protect mechanism

Standard Hanlo gage units must be incorporated in the special gage design to effect savings in both design and manufacturing costs.

*Savings Originate In Design*

These Models Available  
In Two Sizes



Retractable Center  
Available with trigger to hold center in  
retracted position.



Fixed Centers



Spring Loaded Center

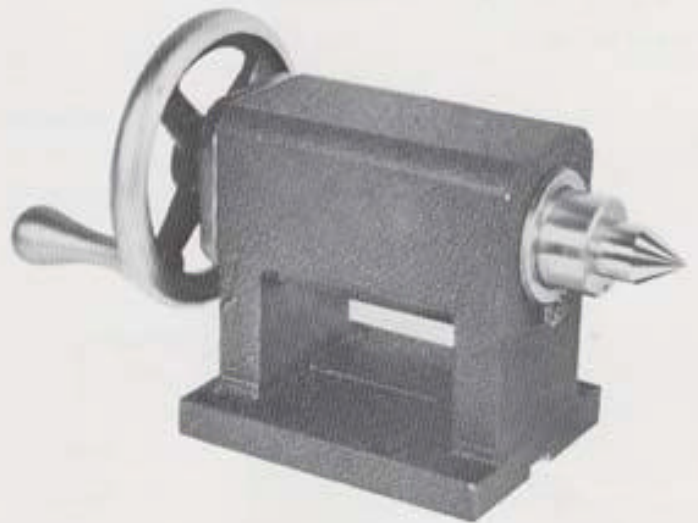

Variable Pressure Center Assembly



# FIXED CENTER ASSEMBLY

**MODEL F-325**

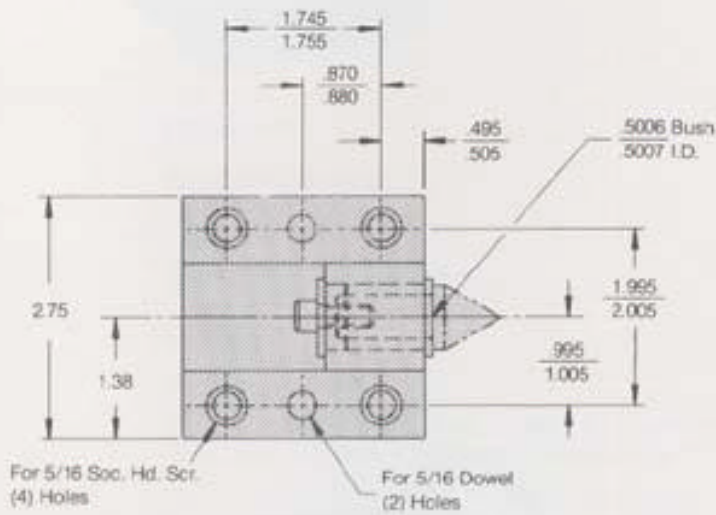

See Page 7  
For Available Centers

Centers Are Not  
Supplied With Unit

See Page 24 For  
Ordering Instructions

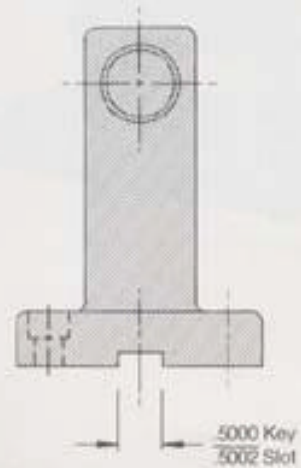
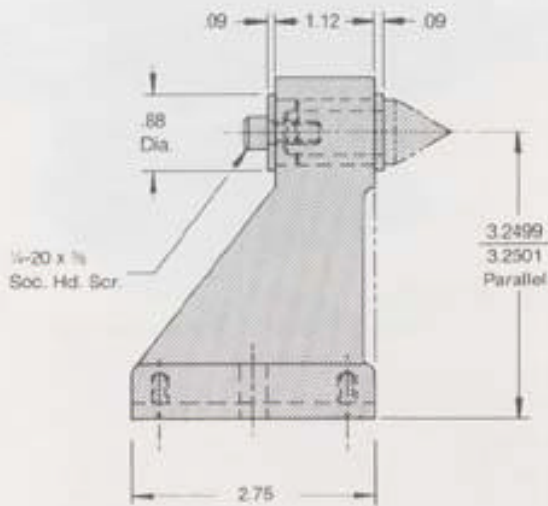



# CENTERS FOR MODEL F-325



Model 325 FS  
Tool Steel

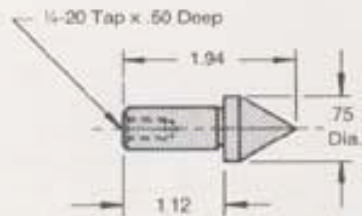

Model 325 FC  
Carbide

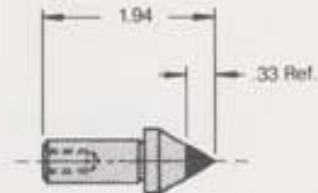

Model 325 FSP  
Tool Steel  
Precision

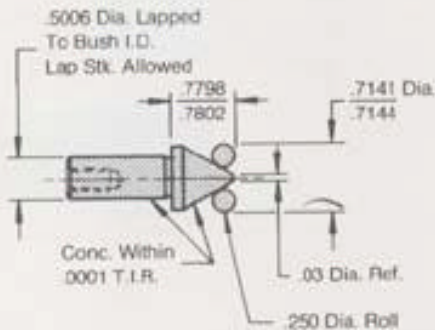

Model 325 FCP  
Carbide  
(Precision)

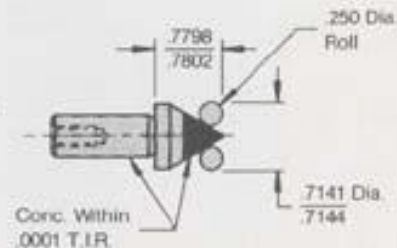

All Dimensions Typical

Model 326 FS  
Tool Steel

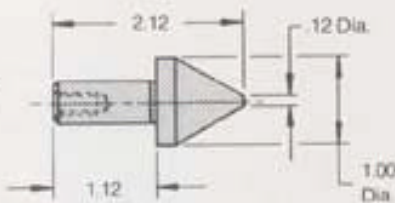

Model 326 FC  
Carbide

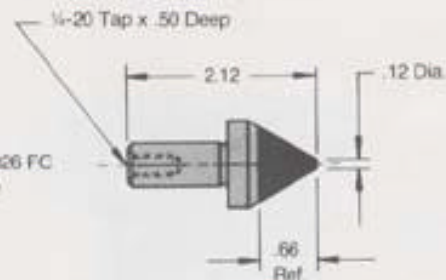

Model 326 FSP  
Tool Steel  
(Precision)

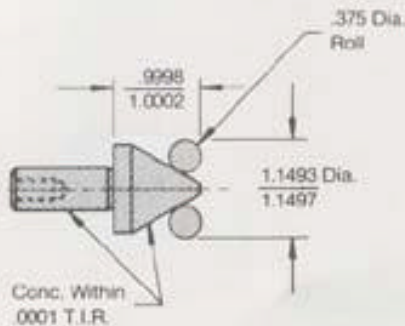

Model 326 FCP  
Carbide  
(Precision)

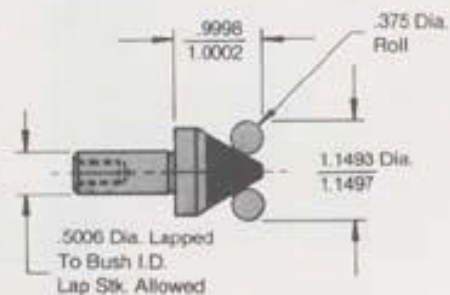

Special Models Quoted Upon Request



# FIXED CENTER ASSEMBLY

**MODEL F-450**

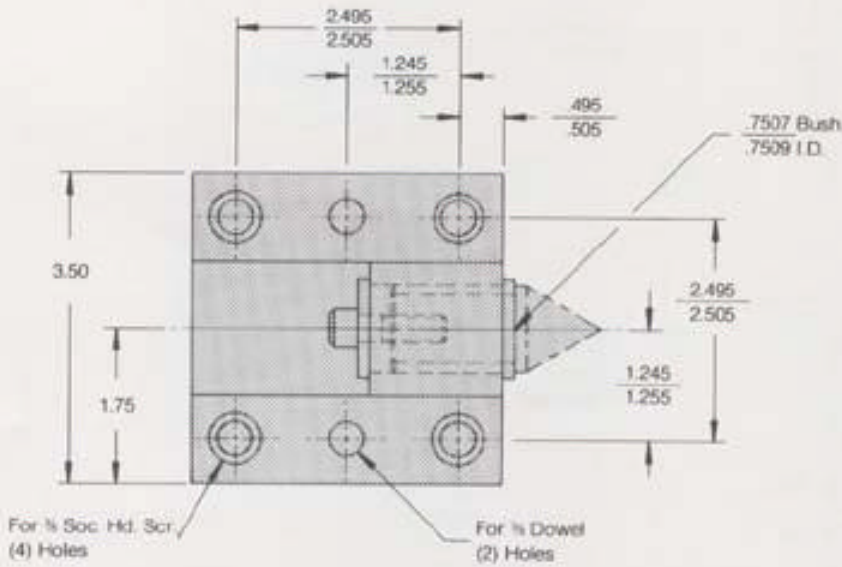

See Page 9  
For Available Centers

Centers Are Not  
Supplied With Unit

See Page 24 For  
Ordering Instructions

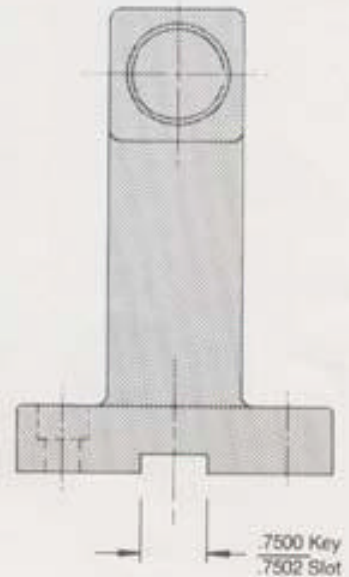
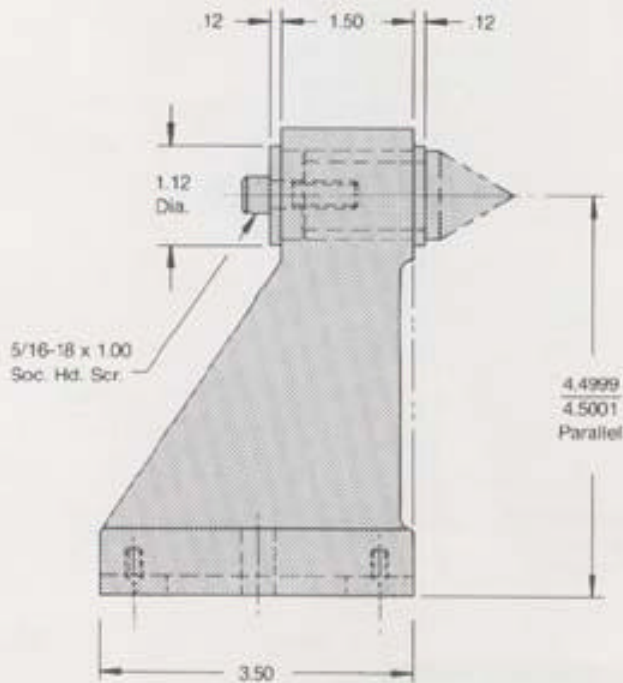

# CENTERS FOR MODEL F-450

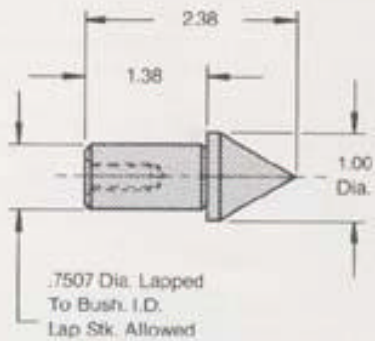

Model 450 FS  
Tool Steel

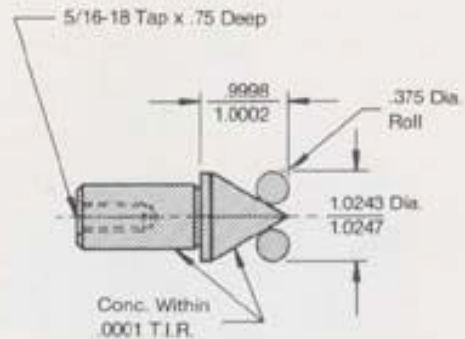

Model 450 FSP  
Tool Steel  
(Precision)

All Dimensions Typical

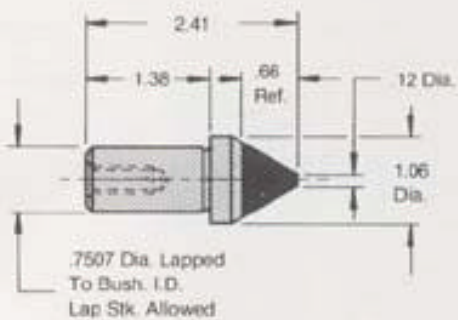

Model 450 FC  
Carbide

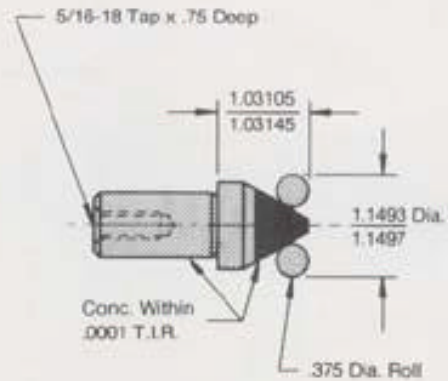

Model 450 FCP  
Carbide  
(Precision)

Special Models Quoted Upon Request



# SPRING LOADED CENTER ASSEMBLY

**MODEL R-325**

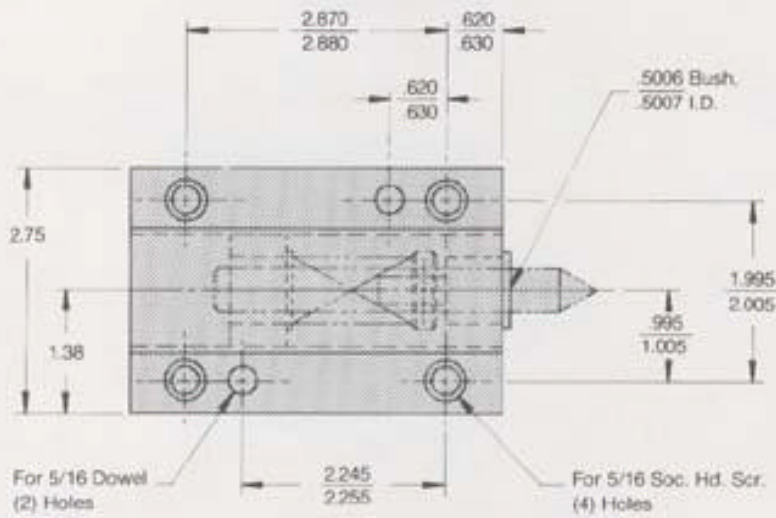

See Page 11  
For Available Centers

Centers Are Not  
Supplied With Unit

See Page 24 For  
Ordering Instructions

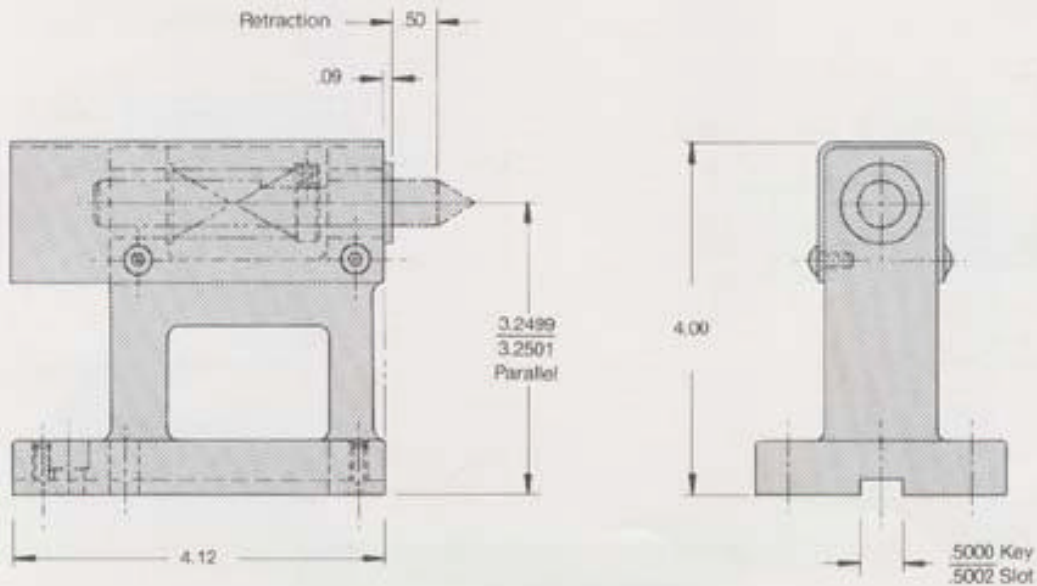

# CENTERS FOR MODEL R-325

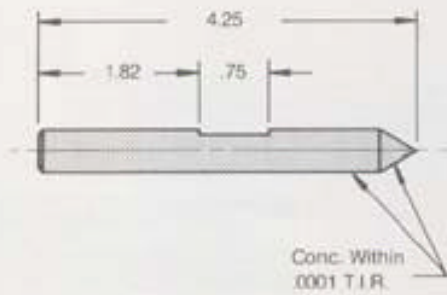

Model 325 S  
Tool Steel

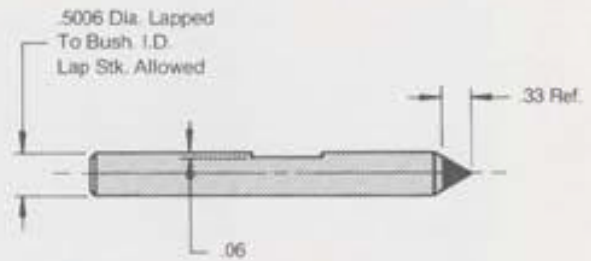

Model 325 C  
Carbide

All Dimensions Typical

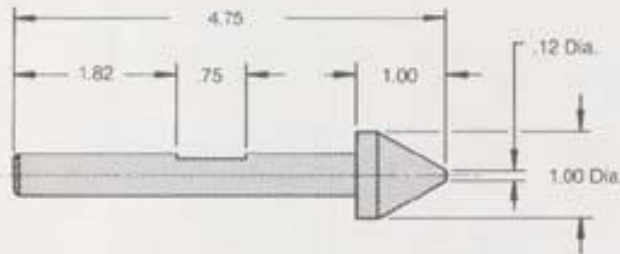

Model 326 S  
Tool Steel

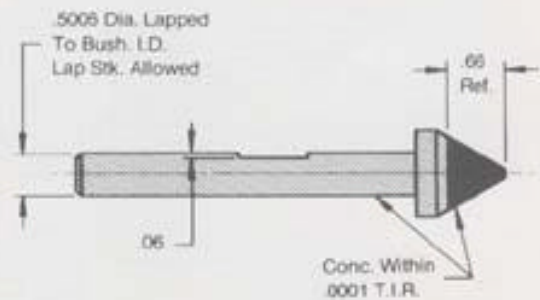

Model 326 C  
Carbide

Special Models Quoted Upon Request



# SPRING LOADED CENTER ASSEMBLY

MODEL R-450

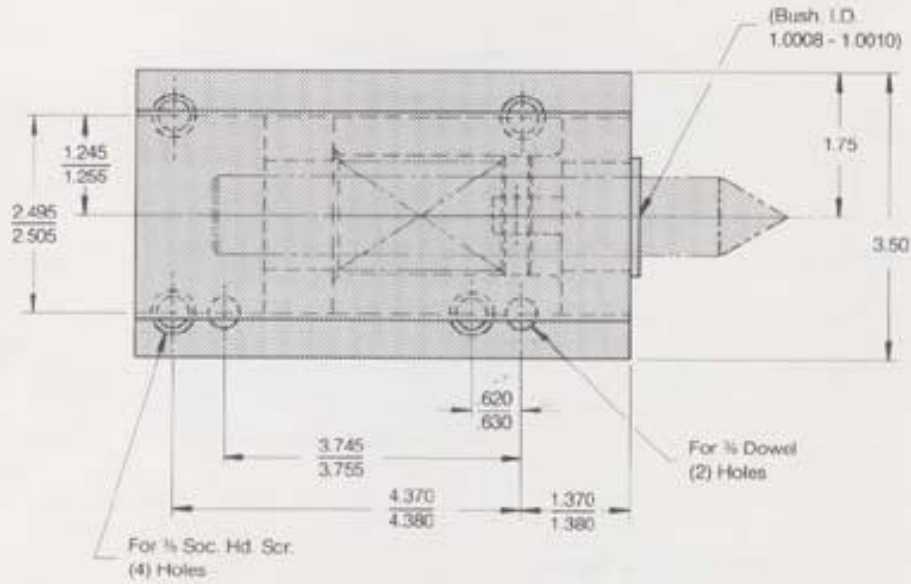

See Page 13  
For Available Centers

Centers Are Not  
Supplied With Unit

See Page 24 For  
Ordering Instructions

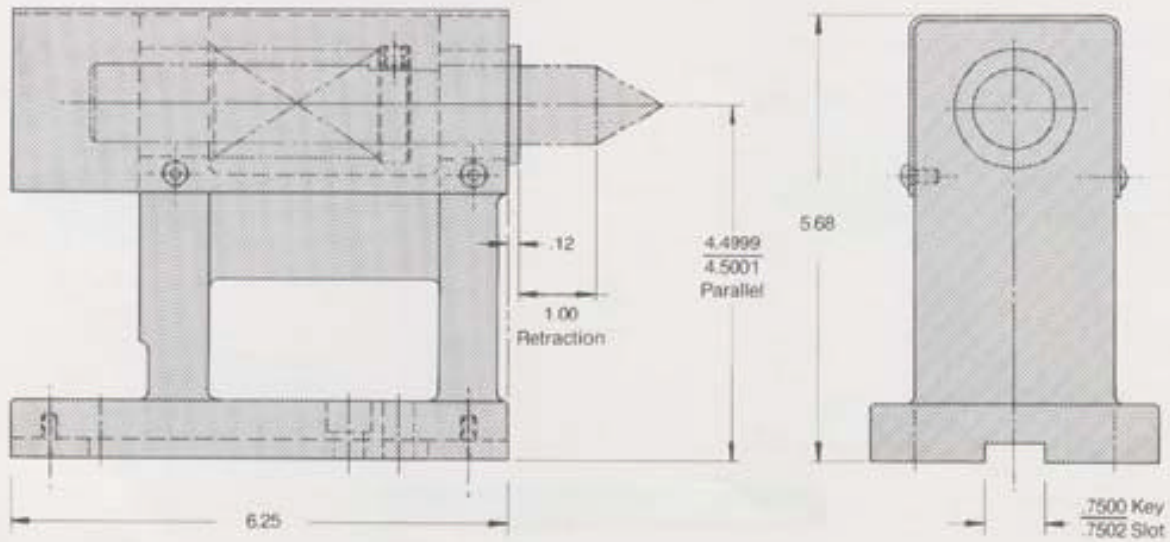

# CENTERS FOR MODEL R-450

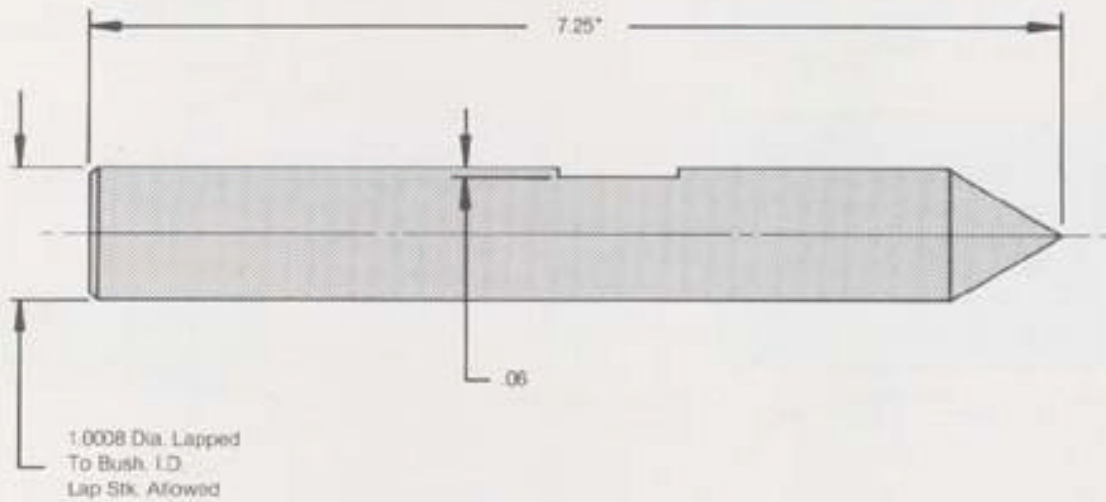

Model 450 S  
Tool Steel

\*All Dimensions Typical Except As Marked

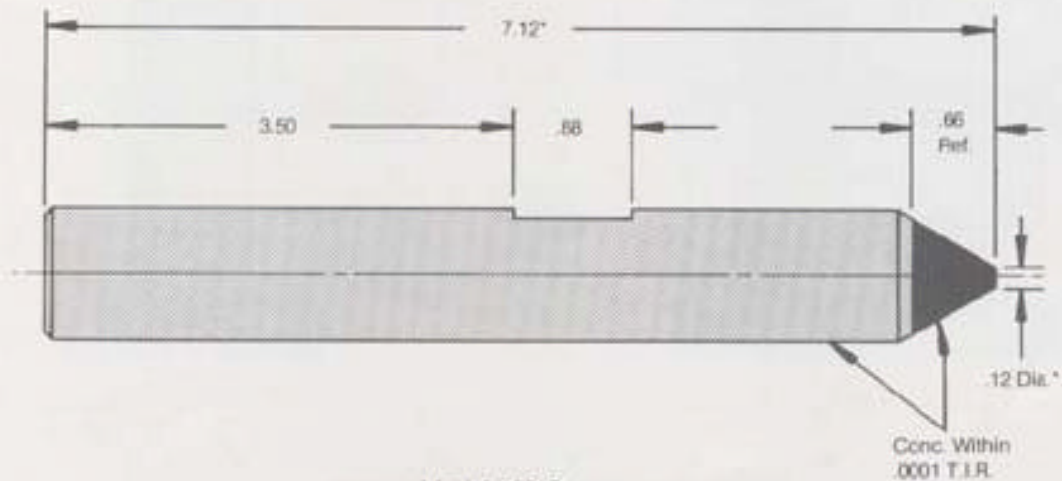

Model 450 C  
Carbide

Special Models Quoted Upon Request



# RETRACTABLE CENTER ASSEMBLY

**MODEL RH-325**

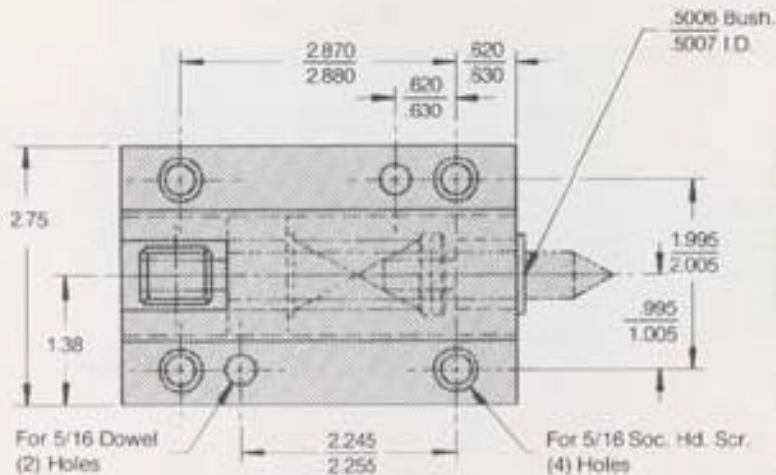

See Page 15  
For Available Centers

Centers Are Not  
Supplied With Unit

See Page 24 For  
Ordering Instructions

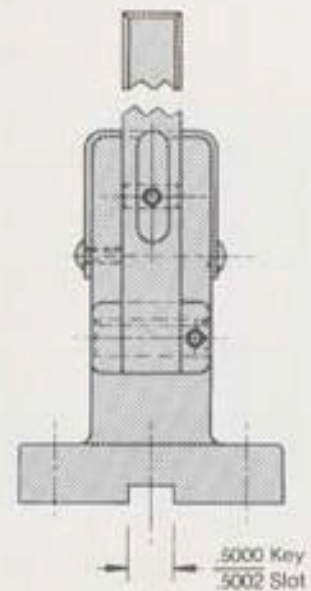
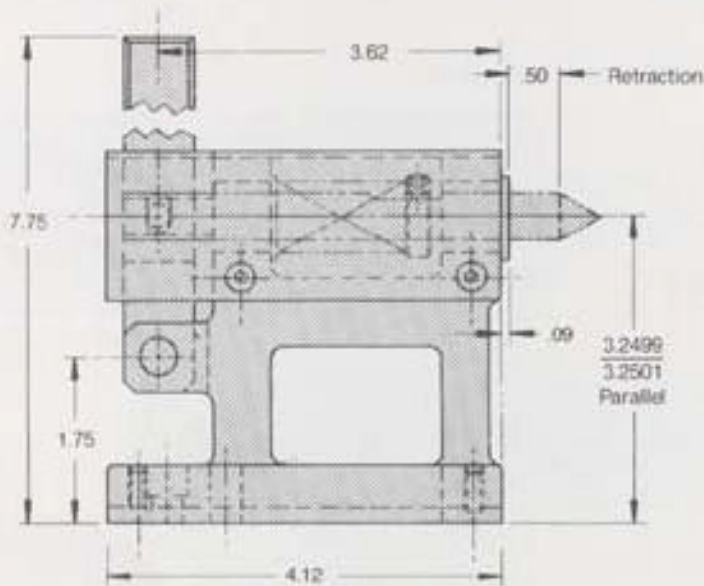



# CENTERS FOR MODELS RH-325 & RHT-325

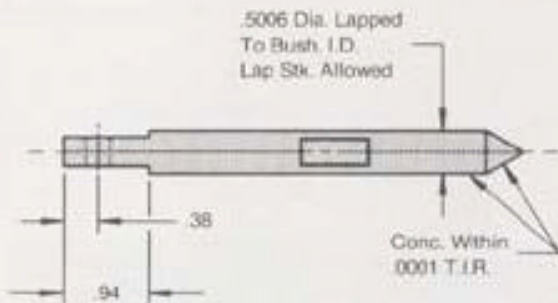

Model 325 HS  
Tool Steel

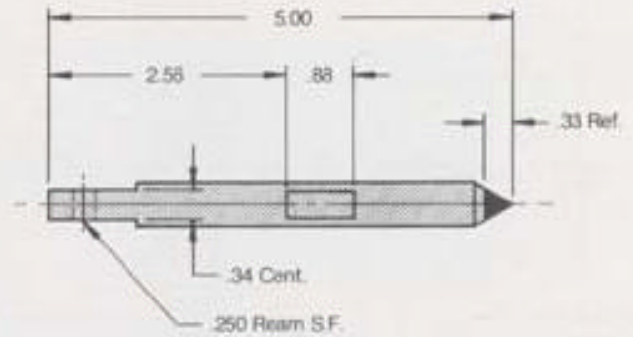

Model 325 HC  
Carbide

All Dimensions Typical

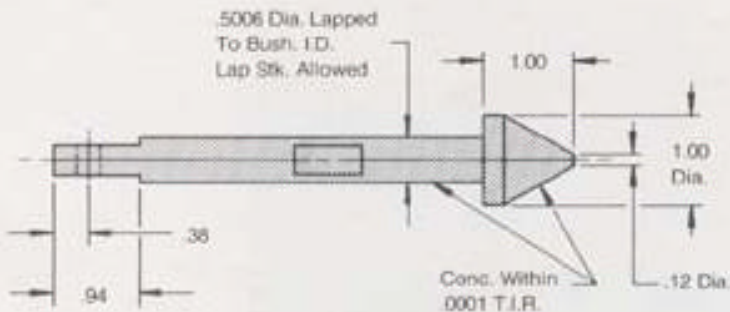

Model 326 HS  
Tool Steel

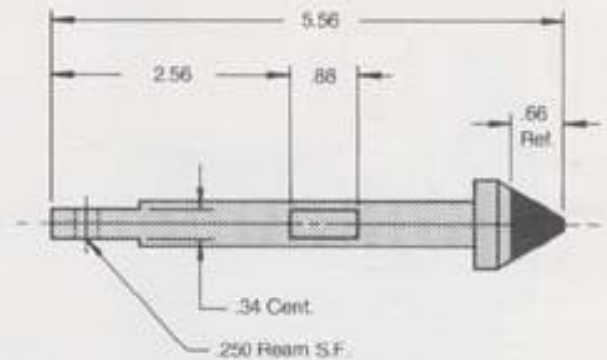

Model 326 HC  
Carbide

Special Models Quoted Upon Request



# RETRACTABLE CENTER ASSEMBLY

**MODEL RH-450**

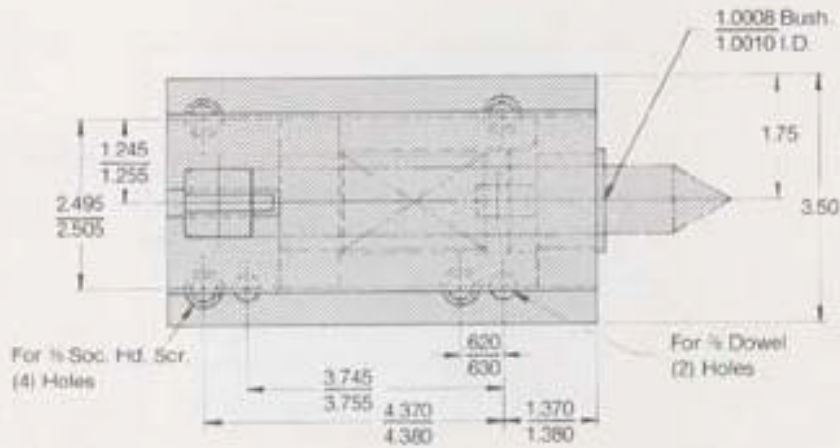

See Page 17  
For Available Centers

Centers Are Not  
Supplied With Unit

See Page 24 For  
Ordering Instructions

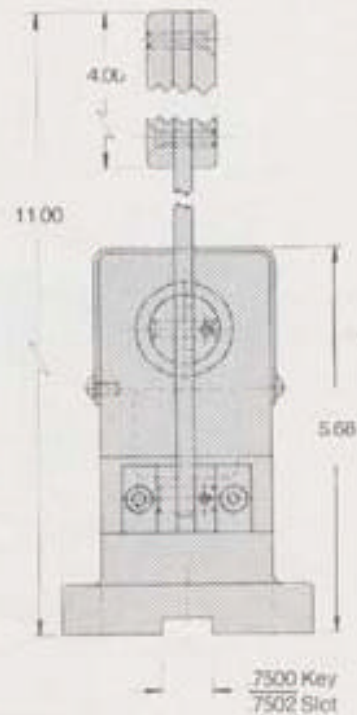
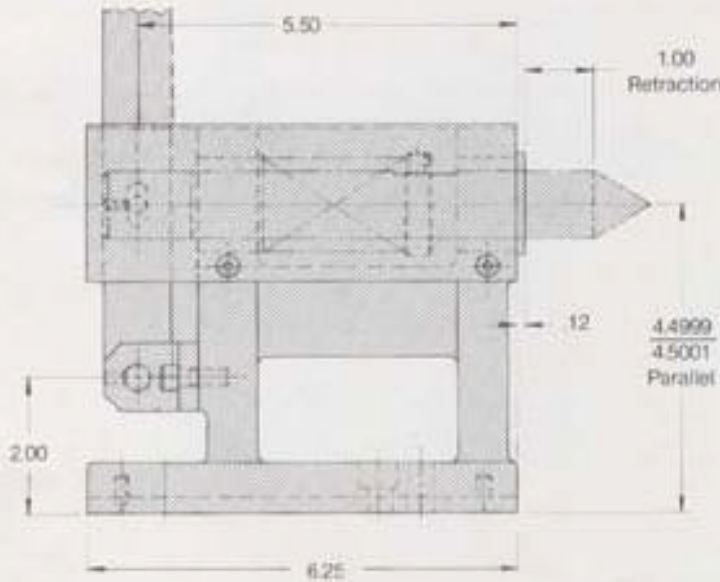

# CENTERS FOR MODELS RH-450 & RHT-450

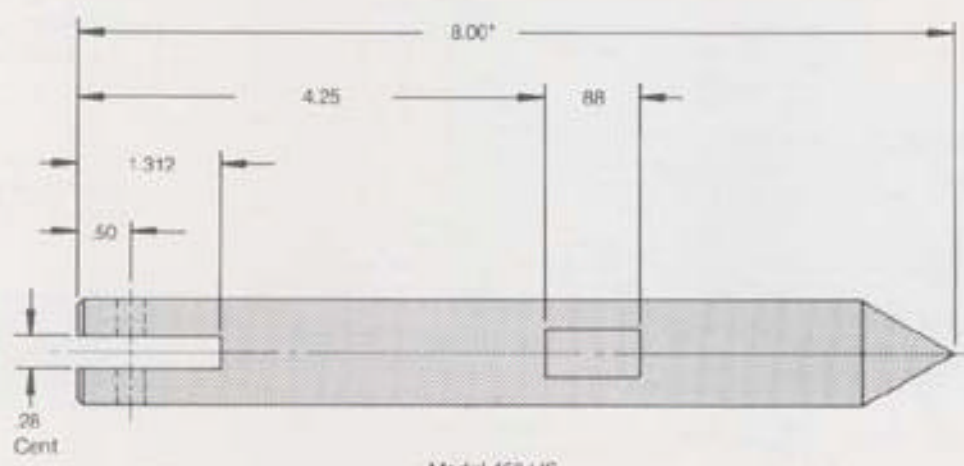

Model 450 HS  
Tool Steel

**\*All Dimensions Typical Except As Marked**

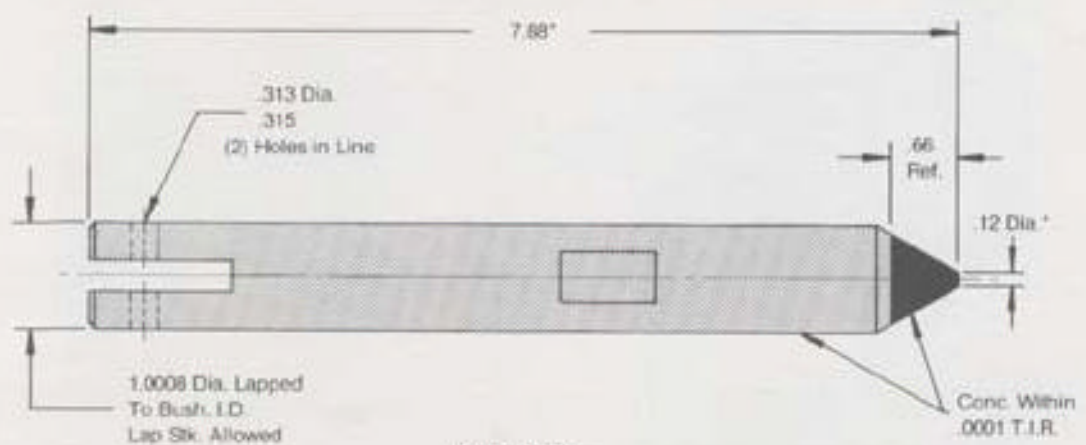

Model 450 HC  
Carbide

**Special Models Quoted Upon Request**

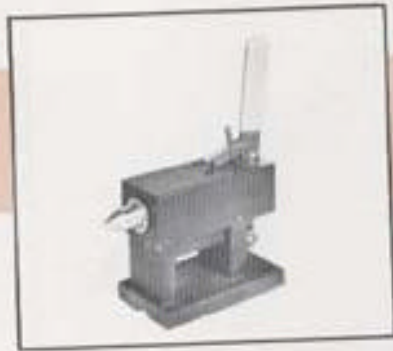

# RETRACTABLE CENTER ASSEMBLY

**MODEL RHT-325**

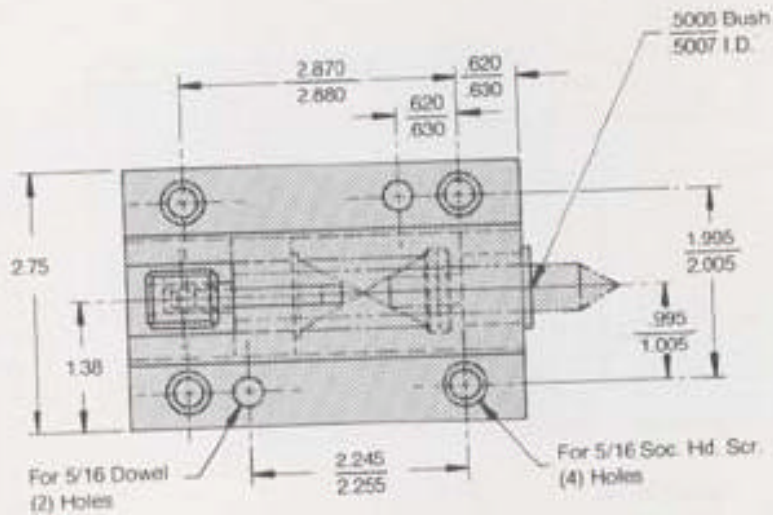

See Page 15  
For Available Centers

Centers Are Not  
Supplied With Unit

See Page 24 For  
Ordering Instructions

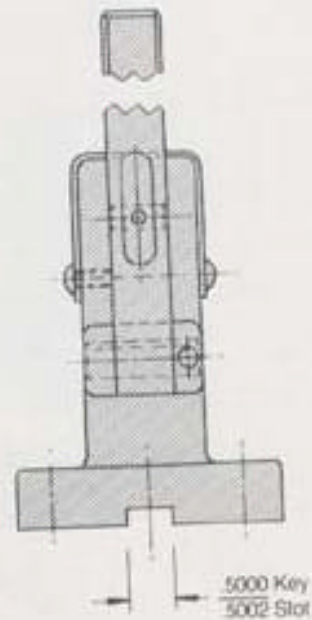
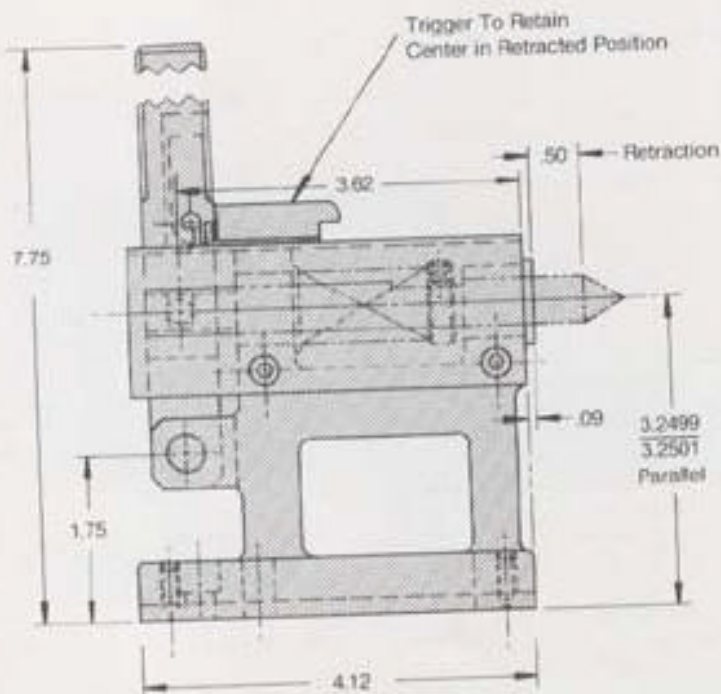

# RETRACTABLE CENTER ASSEMBLY

## MODEL RHT-450



See Page 17  
For Available Centers

Centers Are Not  
Supplied With Unit

See Page 24 For  
Ordering Instructions

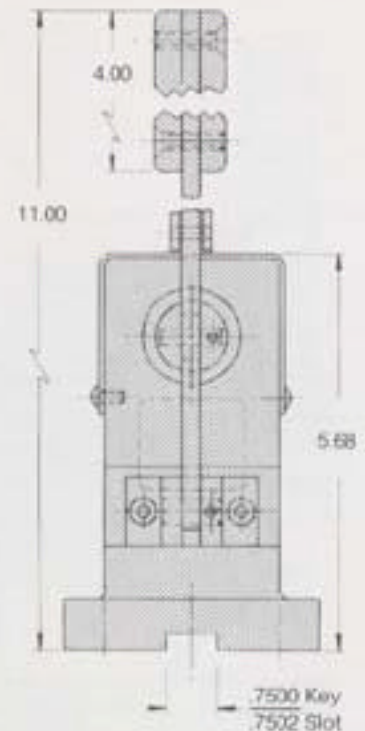
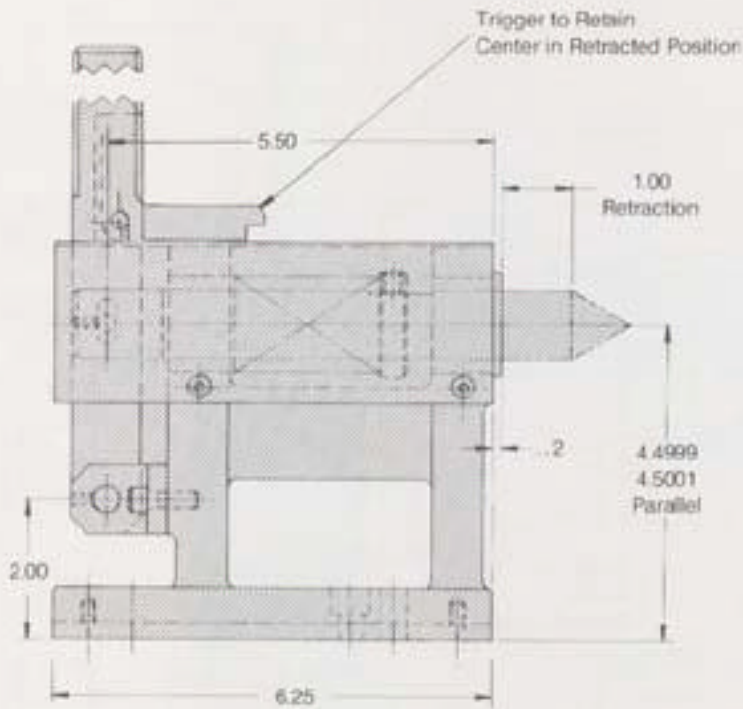
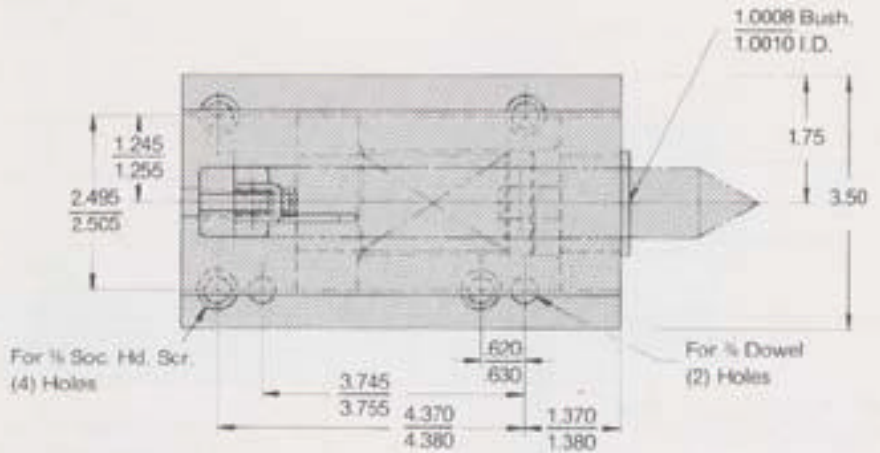



# EXTENDED TRAVEL CENTER ASSEMBLY

**MODEL RHTIS-450**

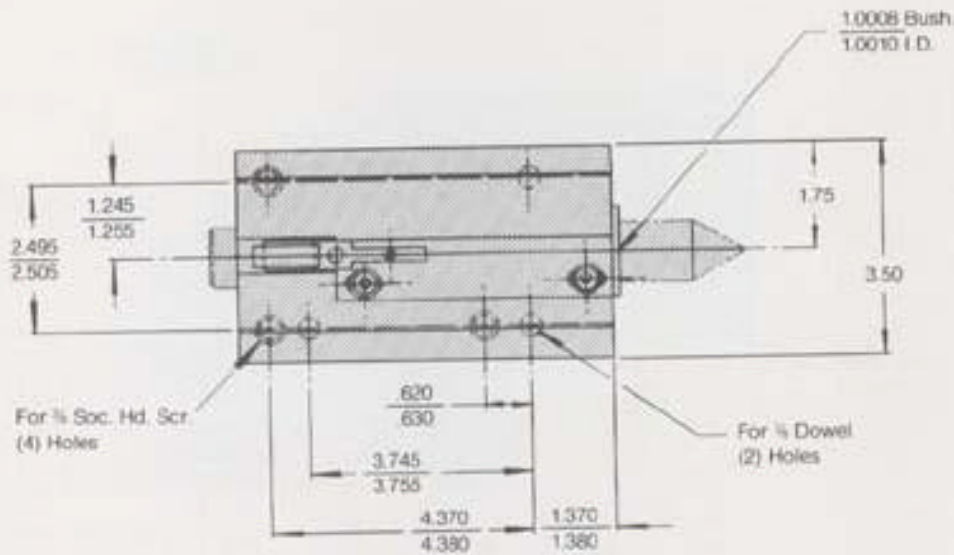

See Page 21  
For Available Centers

Centers Are Not  
Supplied With Unit

See Page 24 For  
Ordering Instructions

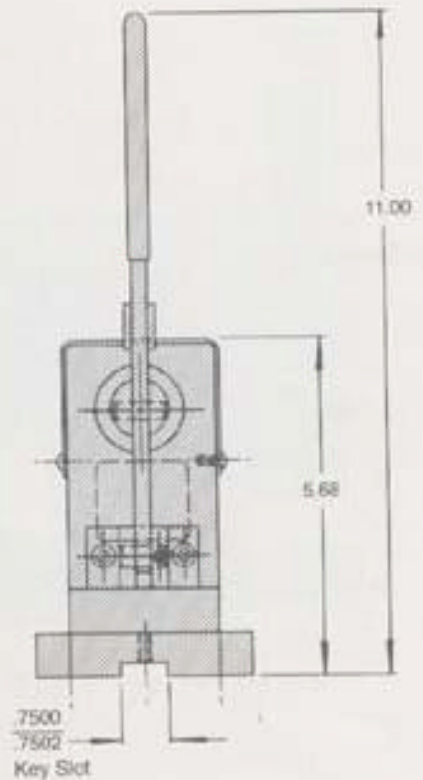
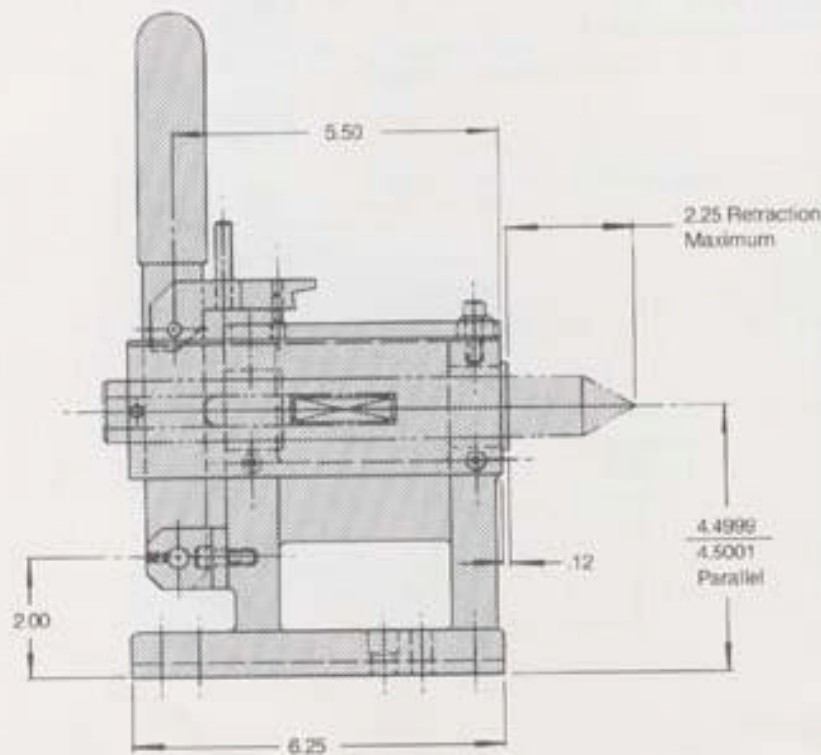

# CENTERS FOR MODEL RHTIS-450

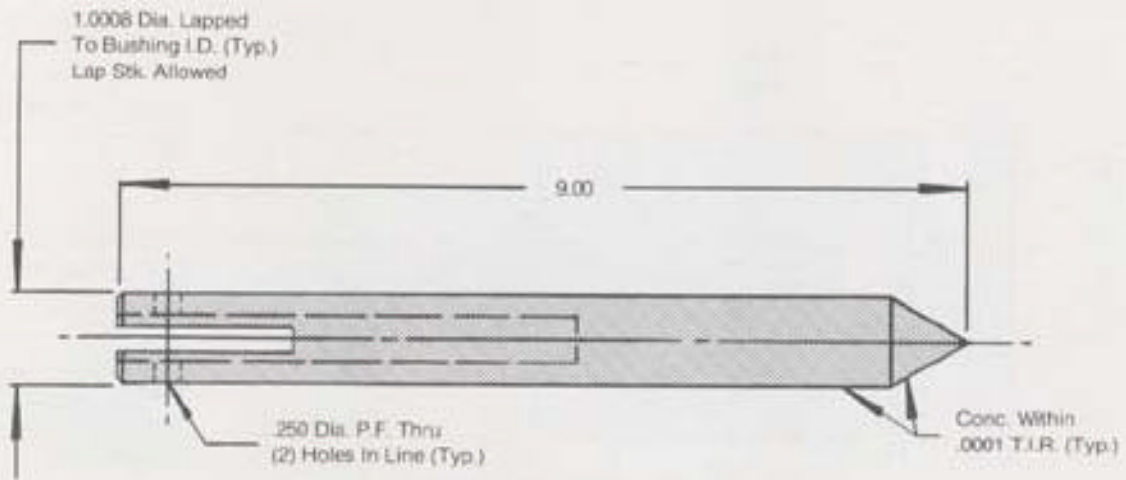
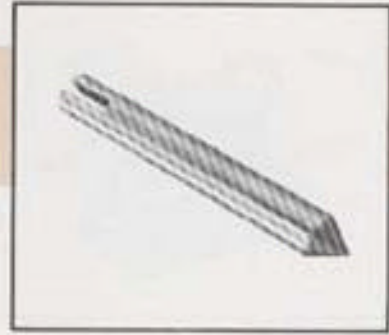

Model 450 ISS  
Tool Steel

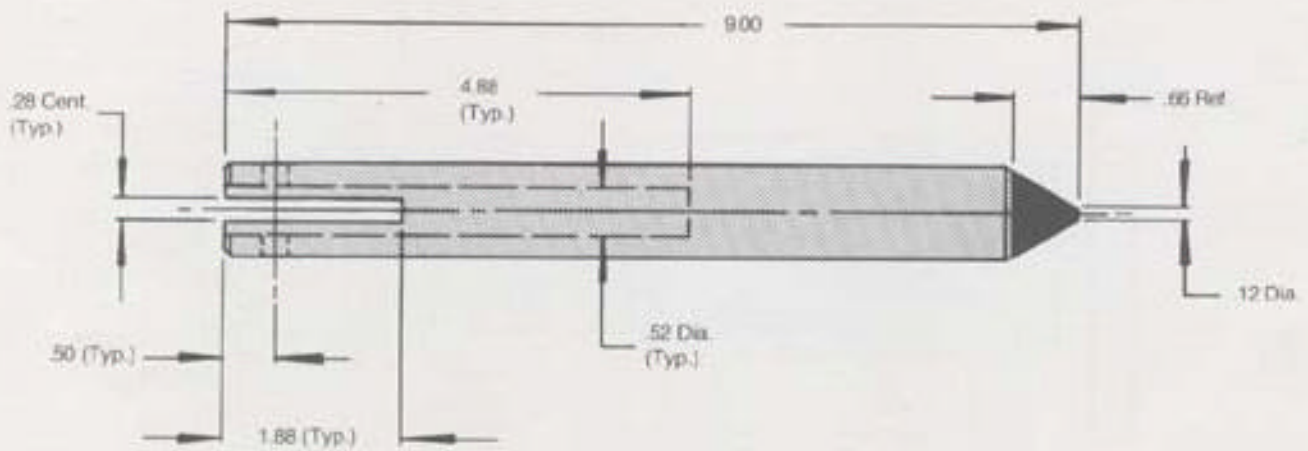

Model 450 ISC  
Carbide



# VARIABLE PRESSURE CENTER ASSEMBLY

**MODEL WTCA-450**

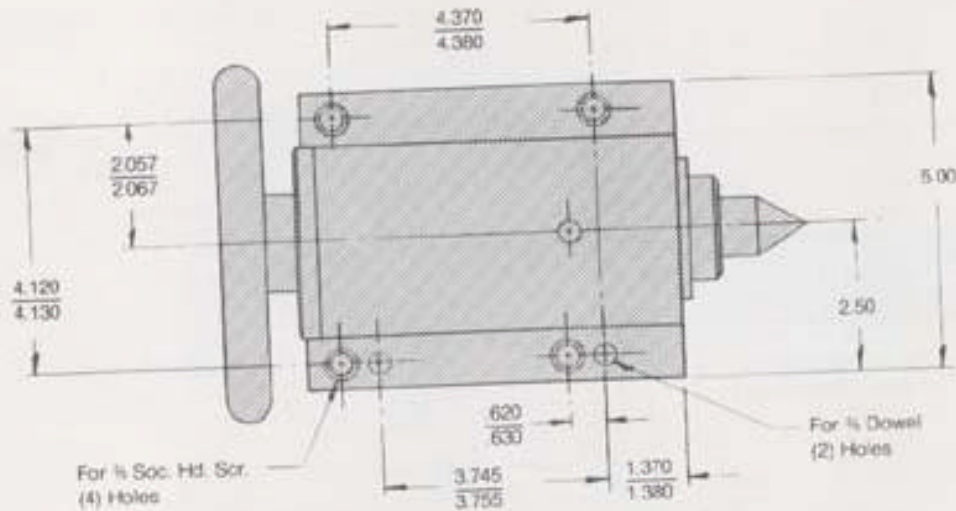

See Page 23  
For Available Centers

Centers Are Not  
Supplied With Unit

See Page 24 For  
Ordering Instructions

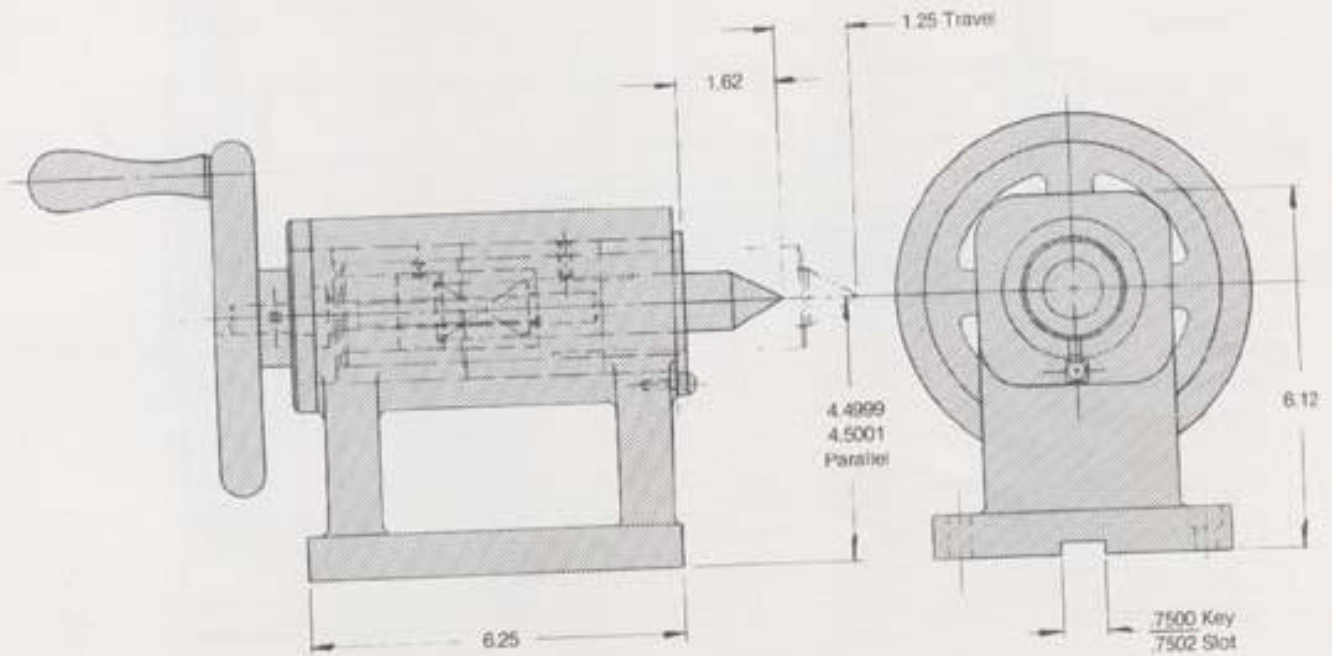



# CENTERS FOR MODEL WTCA-450

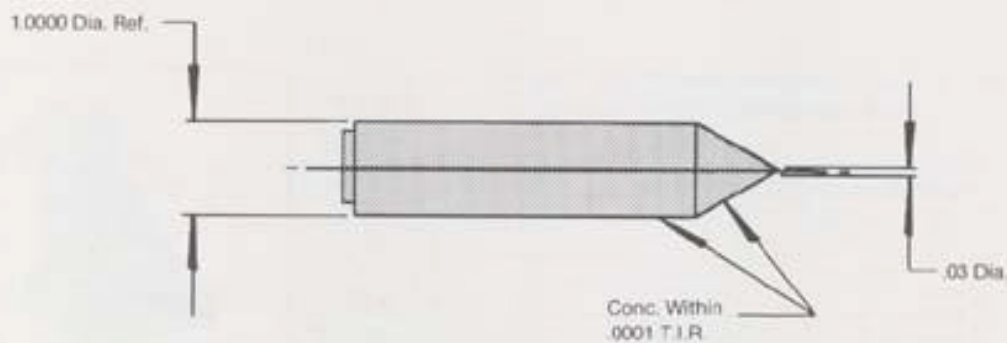

Model 450 WTS  
Tool Steel

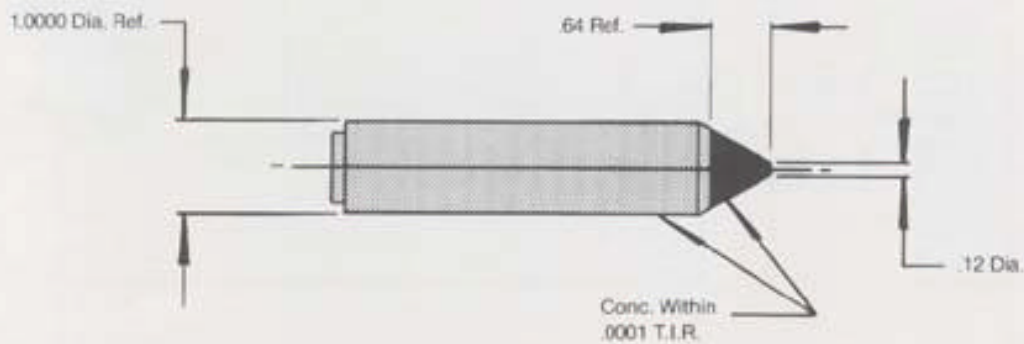

Model 450 WTC  
Carbide

# ORDERING INSTRUCTIONS FOR CENTER ASSEMBLIES

For Ordering Centers With Unit Specify Center No.  
After Model No. of Center Assembly

Example: Fixed Center Assembly F-325 With  
Precision Carbide Center 326 FCP

Hanlo Model F-325 - 326 FCP

Basic  
Assembly  
Model No.

Center  
Model No.



Example: Retractable Center Assembly RH-450  
With Tool Steel Center 450 HS

Hanlo Model RH-450 - 450 HS

Basic  
Assembly  
Model No.

Center  
Model No.



# STANDARD BASE PLATES

## ORDERING

Example: Standard Base Plate—Hanlo

Model #H-564 — B — P  
 Plate      Blanchard      Precision

T x W x L	HANLO MODEL NO.
1- 7/16 x 8 x 12	H — 782
1- 7/16 x 6 x 18	H — 768
1- 7/16 x 8 x 18	H — 788
1- 7/16 x 10 x 18	H — 7108
1- 7/16 x 12 x 18	H — 7128
1-15/16 x 6 x 24	H — 564
1-15/16 x 8 x 24	H — 584
1-15/16 x 10 x 24	H — 5104
1-15/16 x 12 x 24	H — 5124
1-15/16 x 6 x 30	H — 560
1-15/16 x 8 x 30	H — 580
1-15/16 x 10 x 30	H — 5100
1-15/16 x 12 x 30	H — 5120

Blanchard Ground Flat Within .001  
 Precision Ground Flat Within .0002

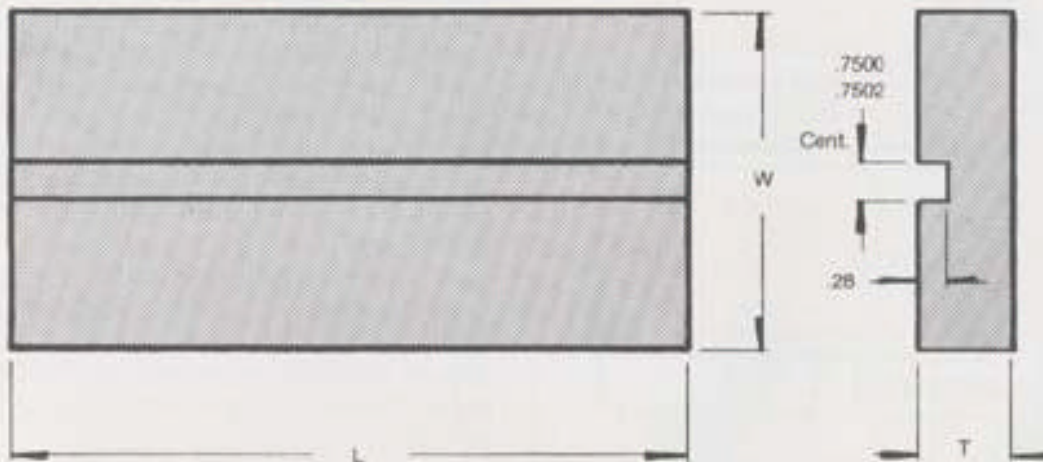

Steel — Normalize

Special Models Quoted Upon Request



## HYDRAULIC ARBORS & CHUCKS

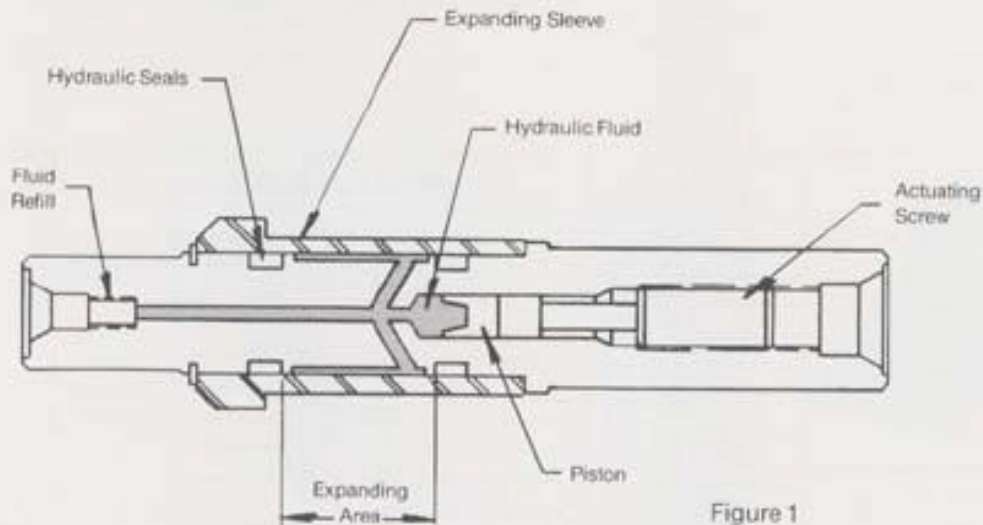

Figure 1

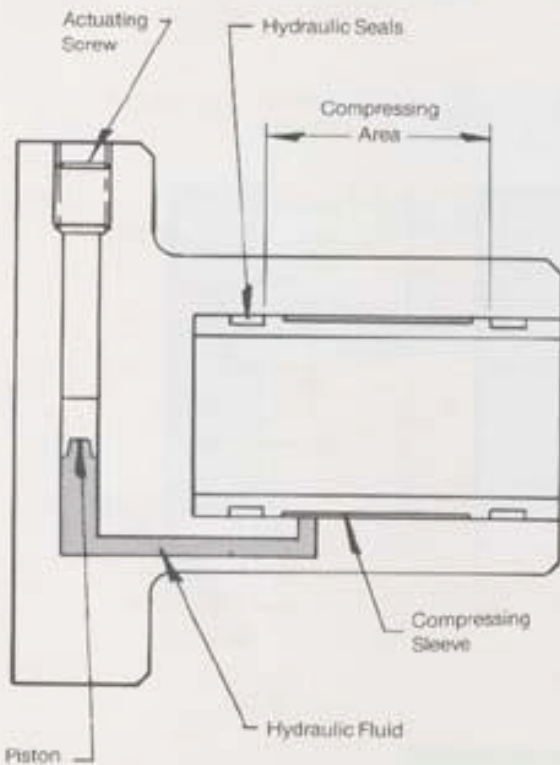

Figure 2

Hanto-Grip arbors and chucks utilize a self contained hydraulic system to expand or compress the sleeve within the gripping area to a point within the elastic limits of the metal. The pressure is supplied through an internal piston assembly which can be actuated either manually or power assisted. The illustrations demonstrate a manual actuation to expand the arbor, or compress the chuck. Clockwise rotation of the actuator screw advances the piston which places the hydraulic system under great pressure. The arbor, Figure (1)—the expansion area is limited by the position of the hydraulic seals. The chuck, Figure (2)—the compression area is limited by the position of the hydraulic seals. There is no expansion of the gripping area beyond the hydraulic seal area. The gripping area of the arbor or chuck is under equalized pressure, with uniform expansion or compression about the geometric center, thus providing extreme accuracy in part positioning.

## ACCURACY

Hanlo hydraulically operated arbors and chucks are normally manufactured to operate within .0002 T.I.R. More precise units are available with tolerances down to .00002 T.I.R. The part variables determine this accuracy.

## GRIPPING — SIZE RANGE

Arbors—minimum bore size 1/4"

Chucks — minimum body size 1/16"

Maximum gripping diameter of chucks and arbors is limited by part configuration and tolerance.

## EXPANSION LIMITS

Hanlo hydraulic arbors and chucks have been engineered and tested to determine maximum material elasticity and provide the following limits:

.003 — first full inch diameter

.001 — each full inch additional diameter

This applies to plain round arbors and chucks. Splined units will accommodate approximately 60% of these limits. Hanlo also offers specially constructed units where holding or accuracy requirements are not as severe as normally needed. Special part configuration of applications may necessitate changes in these values.

## TESTING

All manufacturing, testing, and inspection is done under atmospheric temperature controlled conditions prior to shipment. All units are cycled on Hanlo designed and manufactured test equipment. Hand or power actuated cycles are duplicated during testing. The test equipment insures each unit meets engineering specifications and tests all components involved in manufacture.



# POSITIVE CENTERING

Equalized holding force provides absolute centering accuracy that will conform to the part locating periphery. The arbor or chuck will assure positive holding in parts that may have in-tolerance inaccuracies such as taper, out of round, or bellmouth.

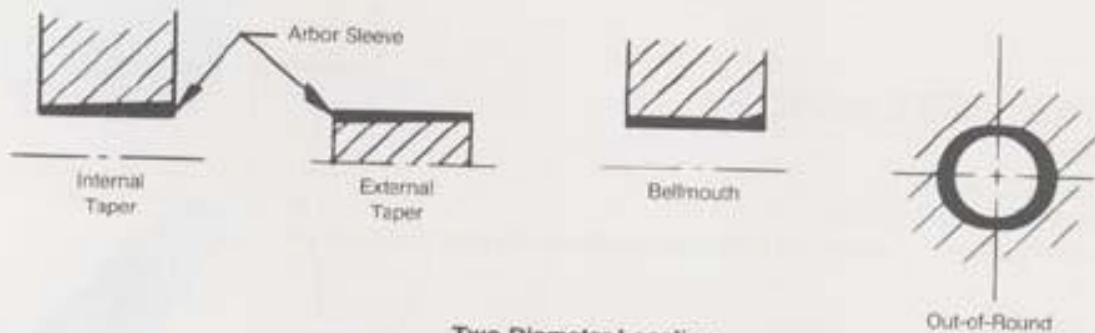

## Two Diameter Location

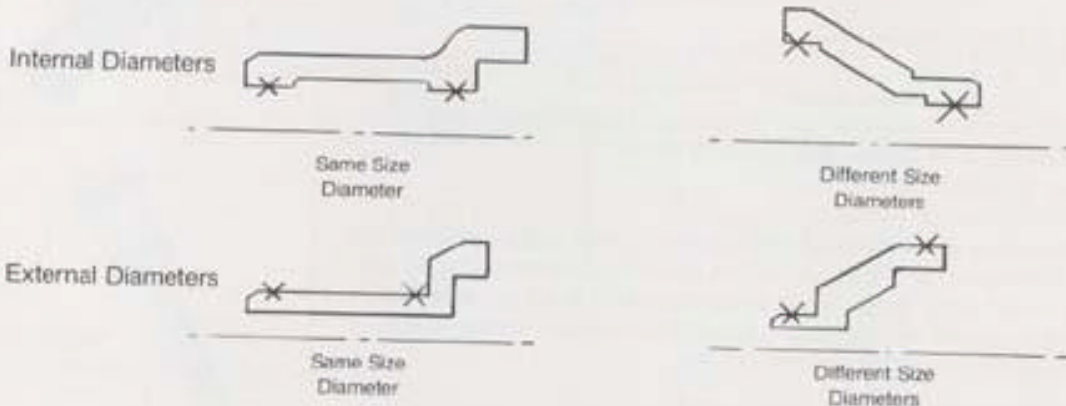

## Multiple Parts



## Hold Similar Parts

With split-sleeve adaptors, similar parts with various locating sizes can be held with one basic arbor or chuck.

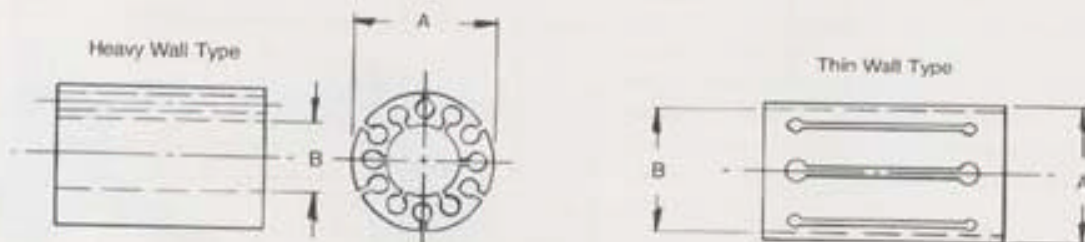

When "A" is basic chuck size, "B" is made to suit part.  
When "B" is basic arbor size, "A" is made to suit part.

NOTE: Basic diameter determines amount of expansion.

# GEARS — SPLINES

Figure 1

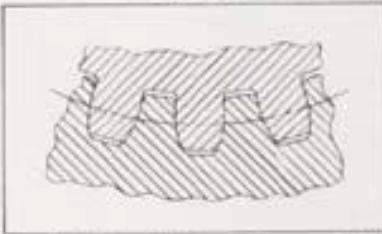

Involute Tooth Form Expanded



Involute Tooth Form Retracted

Figure 2



Spline Retracted



Spline Expanded Locating  
On Major Diameter

- Internal
- External
  - Spur Gears
  - Helical Gears
  - Splines
  - Serrations

The use of Hanlo hydraulic arbors and chucks to establish the geometric centerline of a diameter is proven. Applied to splines and gears, the same principal is achieved by using an arbor or chuck with a gripping sleeve manufactured to a "GO" spline or gear condition. In this condition, equal expansion or compression in each tooth space will establish the part position. This is illustrated in Figure 1. The part can also be positioned by either the minor diameter or major diameter as shown in Figure 2. This same principal can also be applied to threads. To quote these applications, all spline, gear, serration, or thread information must be supplied to determine tolerances involved for the application.



## QUOTATIONS

To Obtain a Quotation, Please Submit the Following Information

1. Print of part or tool and/or process sheets.
2. Locating diameter size, tolerance, and length.
3. Stop surface.
4. Operation to be performed (turn, hob, grind, balance, etc.).
5. Machine spindle dimensions, or type (if fixture mounted supply print of fixture).
6. Specify manual or power actuated.
7. Specify accuracy required of arbor or chuck.
8. If splined part, include all spline dimensions (and prints of "Go" and "Not Go" spline gages if available).

## SERVICE

Hanlo Gage and Engineering Co. will be pleased to work with you to help solve any work or tool holding/locating problem you have.

Hanlo Gage also offers expert capability in repair, modification, or rebuilding of existing hydraulic arbors or chucks you may now have in your plant. All repairs or modifications are handled on a fast as possible delivery.





## APPLICATIONS

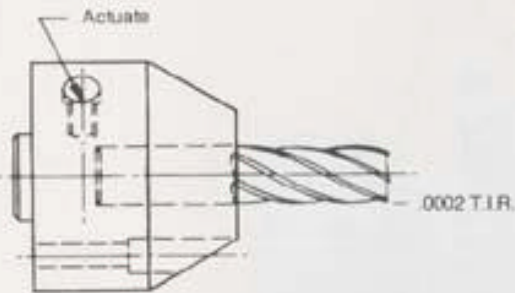

Chuck holding end mill or boring bar. Die Machining, boring, milling, cutter sharpening, etc. Manually actuated. Spindle mounted.

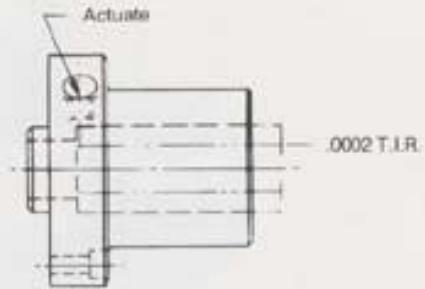

Chuck holding part I.D. grind, boring, inspection, etc. Manually actuated. Face plate or spindle mounted.

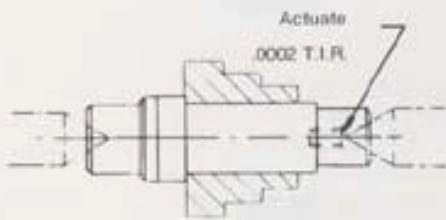

Arbor holding part or tool. Turning, grinding, inspection, hobbing, shaving, etc. Manually actuated. Between centers.

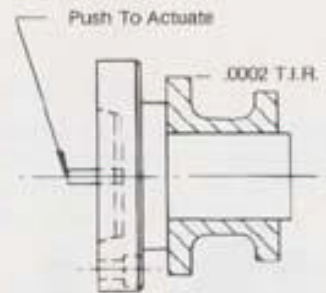

Arbor holding part or tool. Turning, grinding, inspection, hobbing, etc. Power actuated. Face plate or spindle mounted.

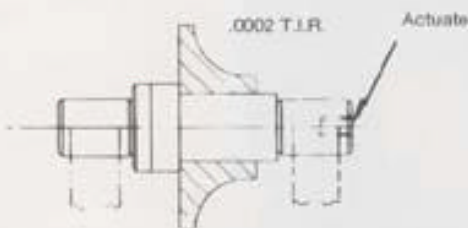

Arbor holding part. Inspection, balancing, etc. Manually actuated. Journal, vee block or roller mounted.

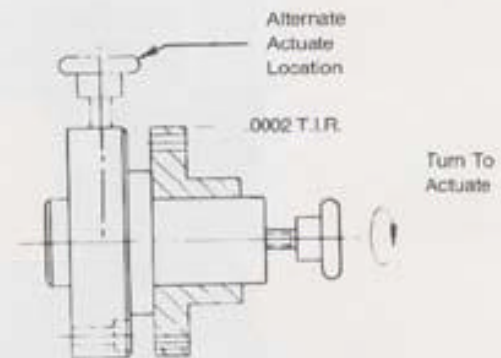

Arbor holding part. Inspection, drilling, milling, boring, balancing, hobbing, turning, grinding, etc. Manually actuated. Fixture or face plate mounted.

The applications shown above reflect but a few of the many possible mountings and machining operations. Hanko-Grip units are adaptable to all operations and machines where outdated or inaccurate holding devices are normally used.

## APPLICATIONS

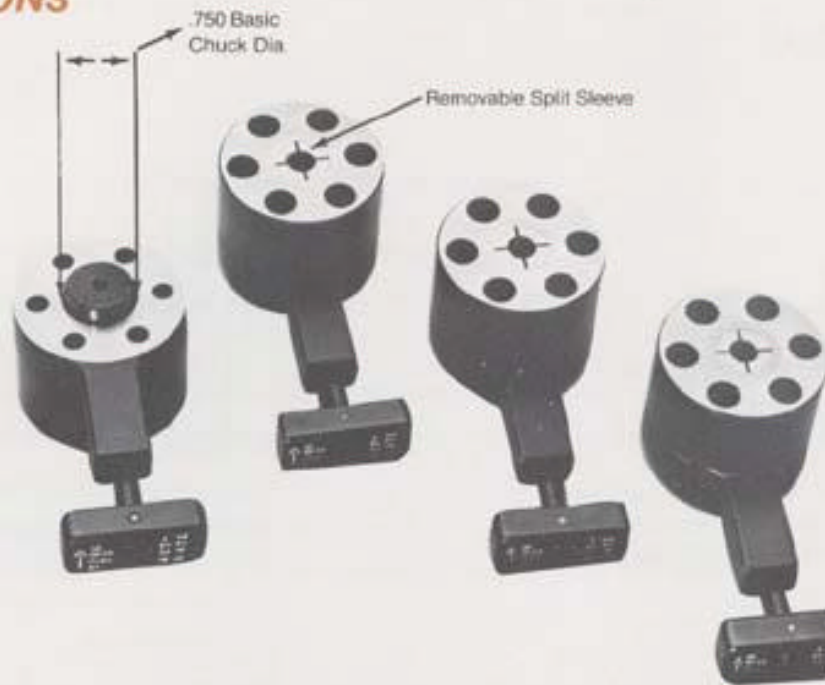

Hanlo-Grip hydraulic chuck with removable split sleeves to grip parts from 3/4 to 5/16 diameters.

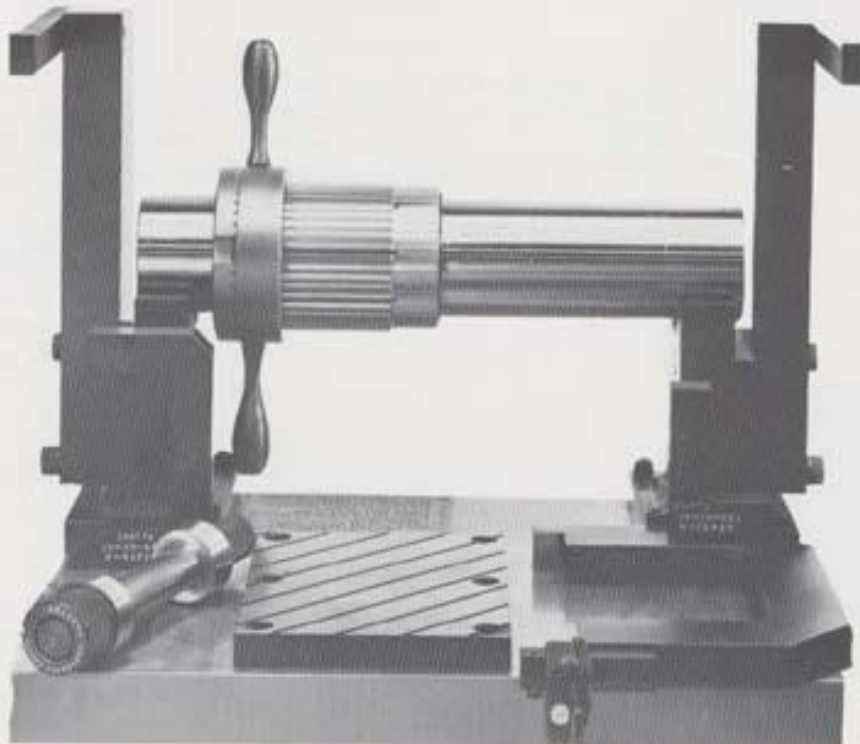

Inspection fixture utilizing Hanlo-Grip hydraulic splined arbor locating on the part pitch diameter.

## APPLICATIONS



Squareness gage to check pinion face to pinion bores. Hanlo-Grip arbor and various split sleeves are inserted into the pinion bores to establish the true center line. Adjustable indicator arm assembly is piloted over a shaft on the arbor and rotated for the squareness check.



Combination Hanlo-Grip arbor and sweep gage to check concentricity of one bore to another.

# ENGINEERING & MANUFACTURING

FIXED LIMIT GAGES

INDICATOR GAGE COMPONENTS

INDICATOR GAGE ASSEMBLIES

FIXTURE GAGE COMPONENTS

ELECTRONIC GAGES

AIR GAGES

FIXTURE GAGE SYSTEMS

AUTOMATIC GAGE SYSTEMS

MASTERS

COMPLETE FACILITIES FOR REWORK & REPAIR

HANLO  
GAGES

**HANLO**  
GAGE & ENGINEERING CO.